



patiola®

patiola® ST 3300

E468/100

01/06

Electric operation

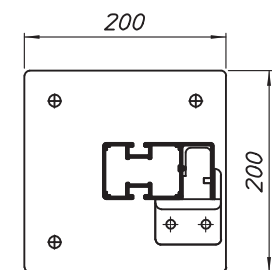
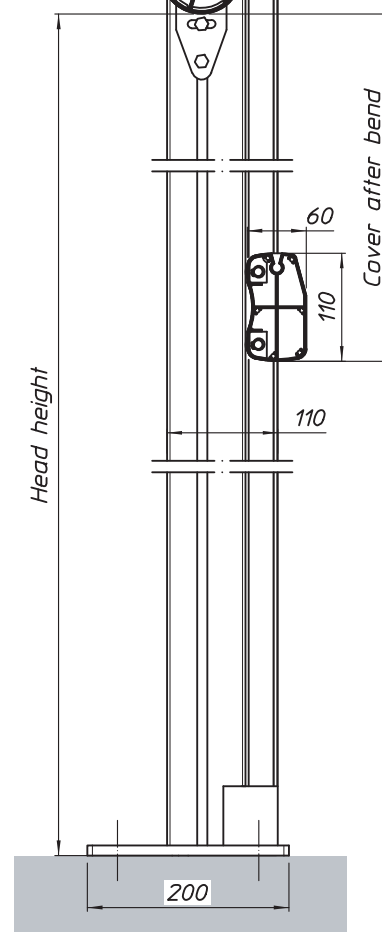
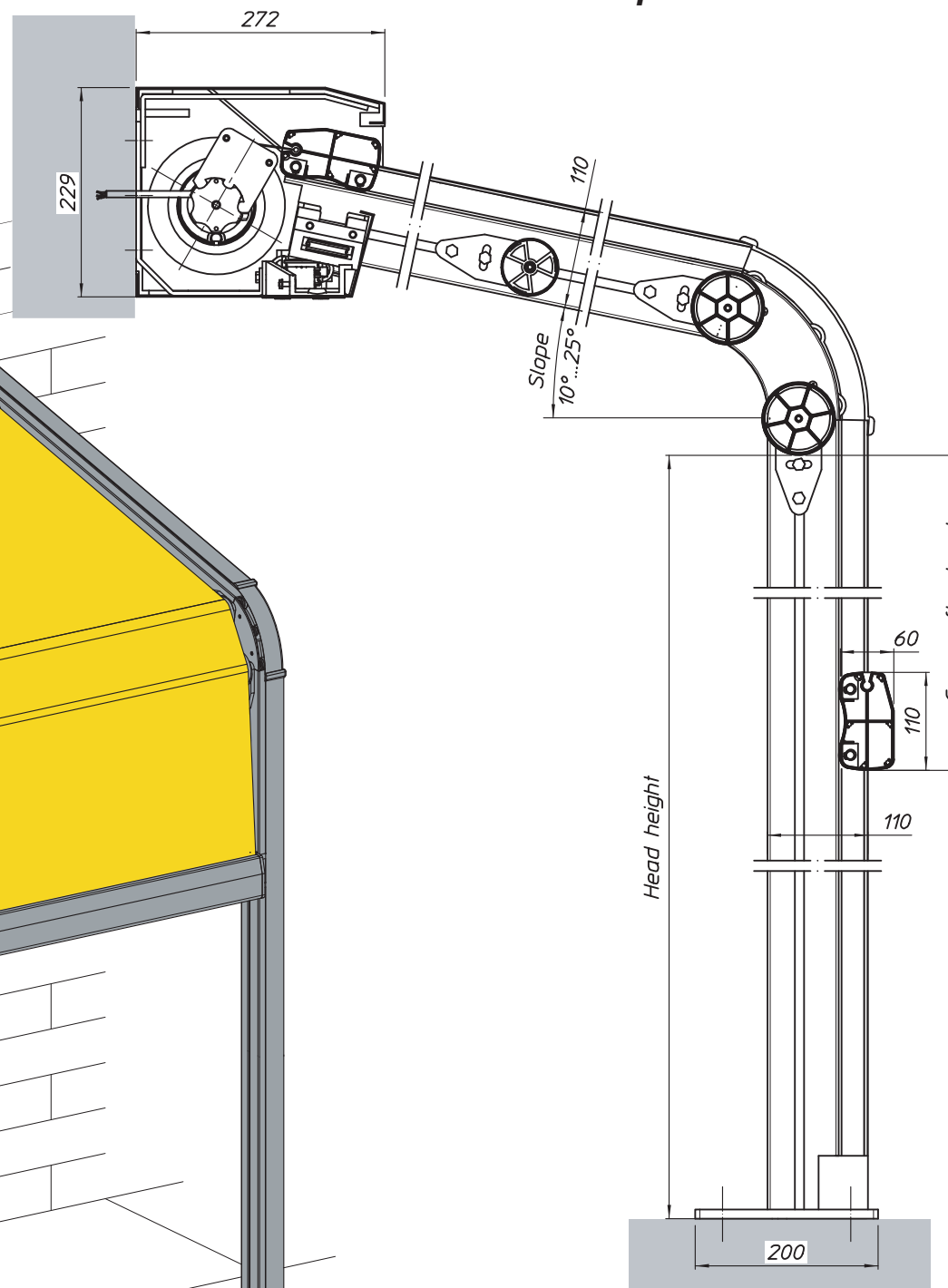
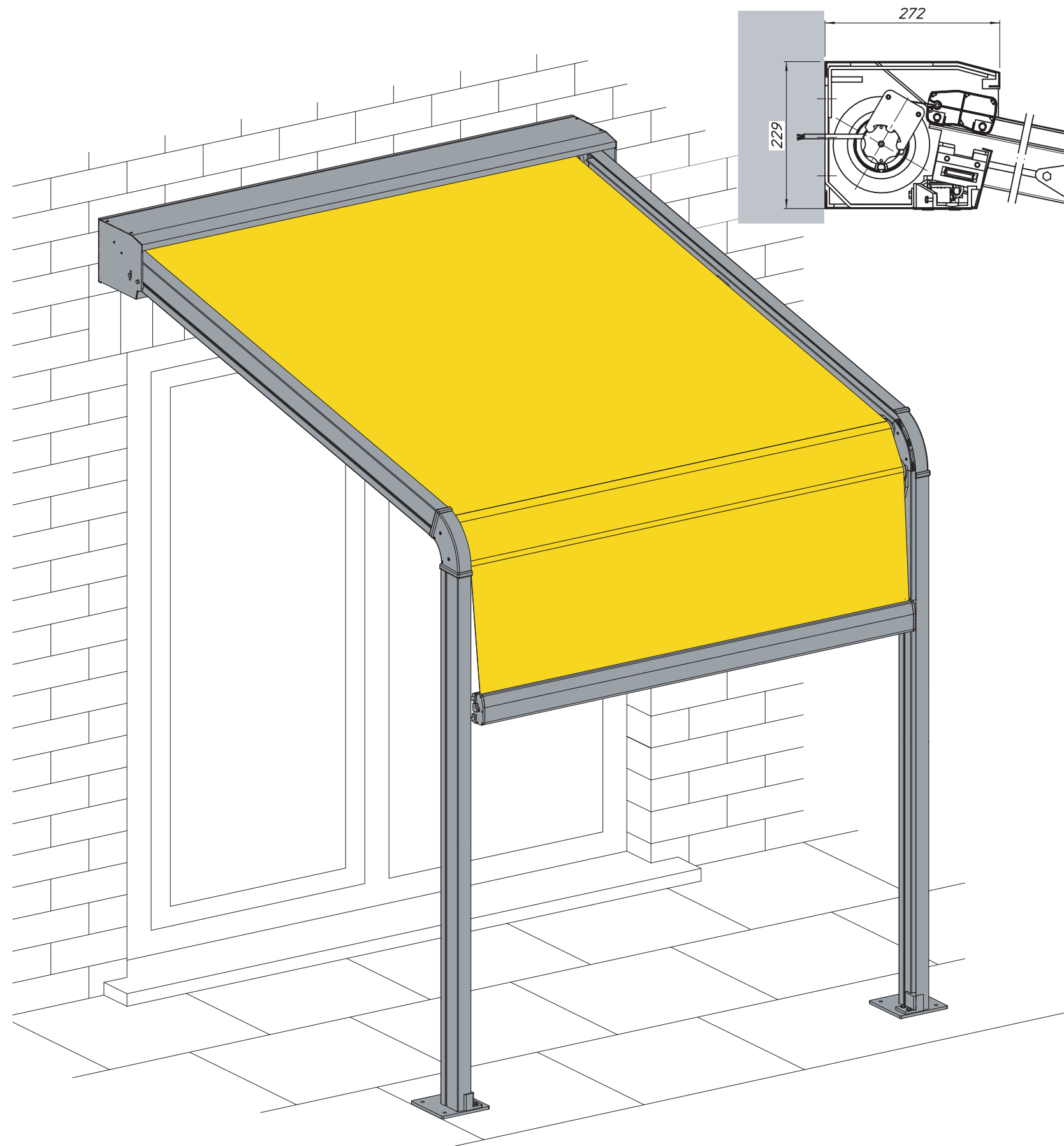

Different positions of the side channel see page E468/151

APPLICATION

A cassetted awning, with sloped and vertical side guides which make it a self-supporting structure. The fabric softens the light, absorbs and reflects the heat of the sun. Fitting involves fixing the case to the wall, the vertical side channels to the supporting-plates, and tensioning the fabric. Electric operation. Can be used for covering terraces of private homes, restaurants and pub gardens.

TYPES - LIMITS

The user limits of this awning with a 229 x 272 mm case can be viewed on a graphic.

- 1 unit: min width 2,50 m
- max. width: 5,00 m
- max. straight projection: 6,00 m
- max. surface: 30,00 m

Several units can be installed next to each other to cover larger surfaces.

EXECUTION

- Case with end caps, side channels with supporting plates, corner rollers, intermediate rollers and front profile with aluminium end caps. All powder coated in white RAL 9010 or ivory RAL 1015.
- Waterproof fabric (collection Diklon 50 TT)
- Supporting plates with pre-drilled fixing holes and adjustable positions for the side channels according to the chosen framing.

OPTIONS - extra charge

- **Case, rollers and front profile**
 - Can be powder coated in any RAL-colour.
 - Gutters.
 - Back plate for case.
 - Lighting bar.
- **Fabric**
 - Side blinds.
 - Sign writing.
- **Electric operation**
 - Steering for additional fabric tension (CMTI)
 - Electric cable longer than 3m (5 or 10m)
 - Automation: group control, remote control, sun and wind sensor, clock,...

MAINTENANCE - REPAIR

- Maintenance: remove dust from the fabric with a semi-soft brush, clean with water and non-aggressive detergent. Hinges and bearings should be oiled (with thin oil) once a year.
- In case of repairs or rope breakage the patiola usually has to be dismantled; mount the units in an accessible position.

FIRE CLASSIFICATION

- Frame in aluminium: no classification.
- Fabric: -waterproof quality: no classification.

GENERAL

- Everything is made to measure.
- Prices, documentation, colour samples: ask your representative or contact Winsol UK Ltd.
- Guarantee: see guarantee form.
- Technical building assistance and references are available on demand.
- Specification: see technical brochure.

Front view

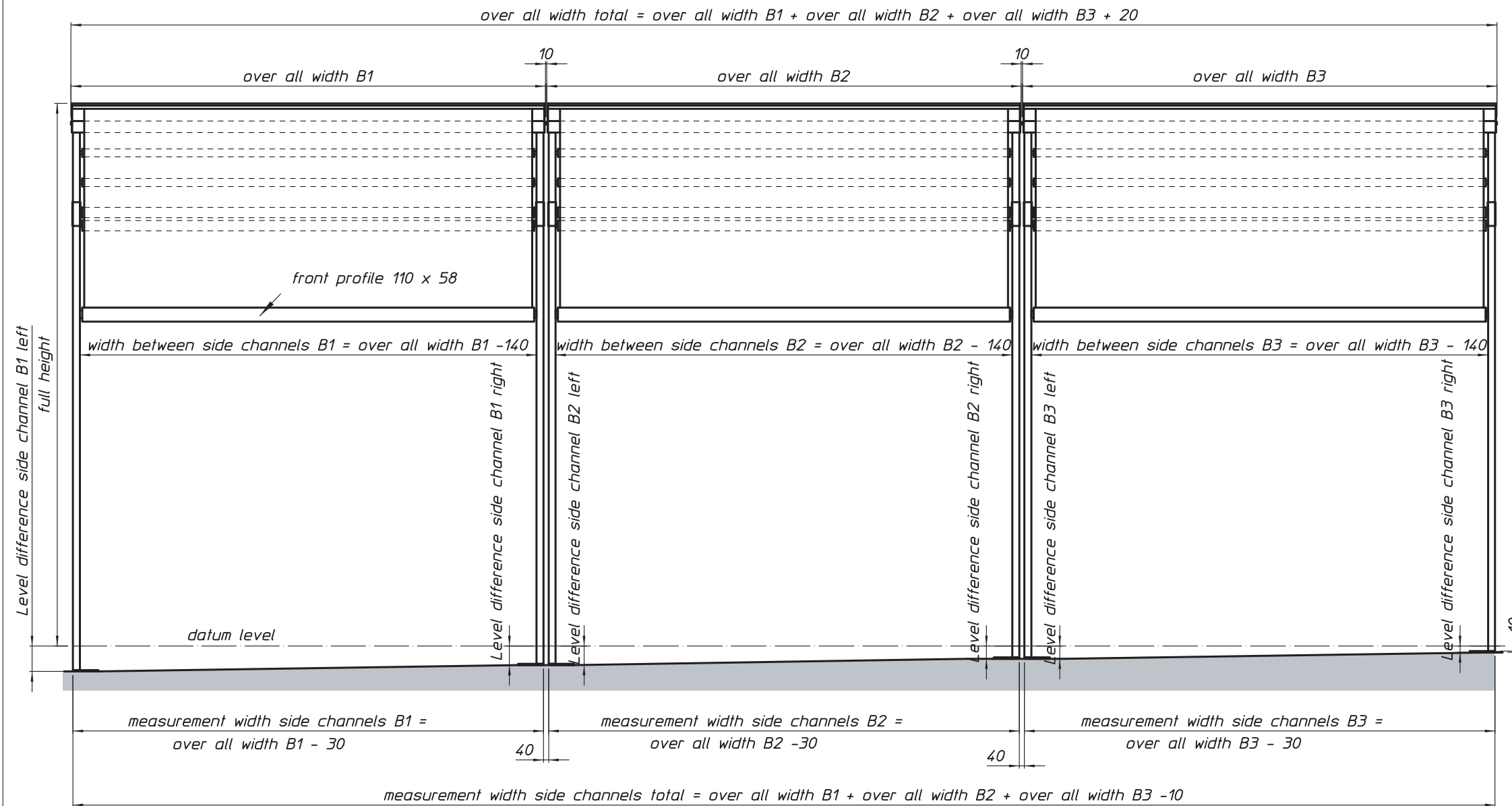

patiola®

patiola® ST 3300
Measurement 3 parts

E468/136

01/06

Top view

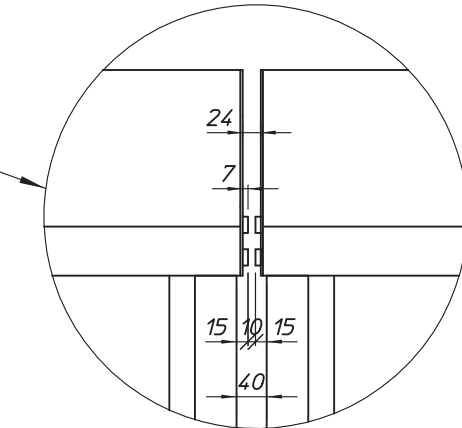
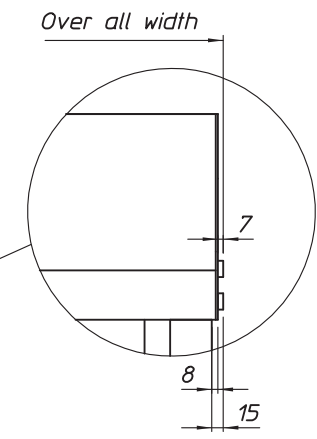
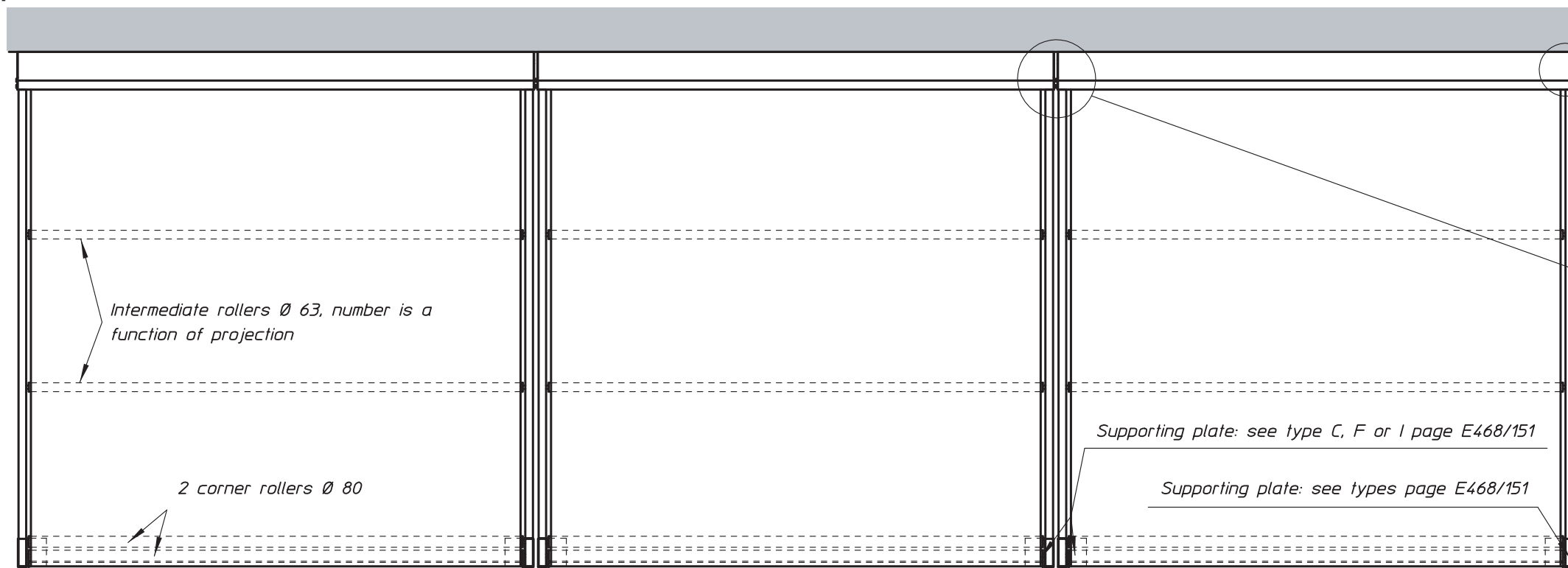

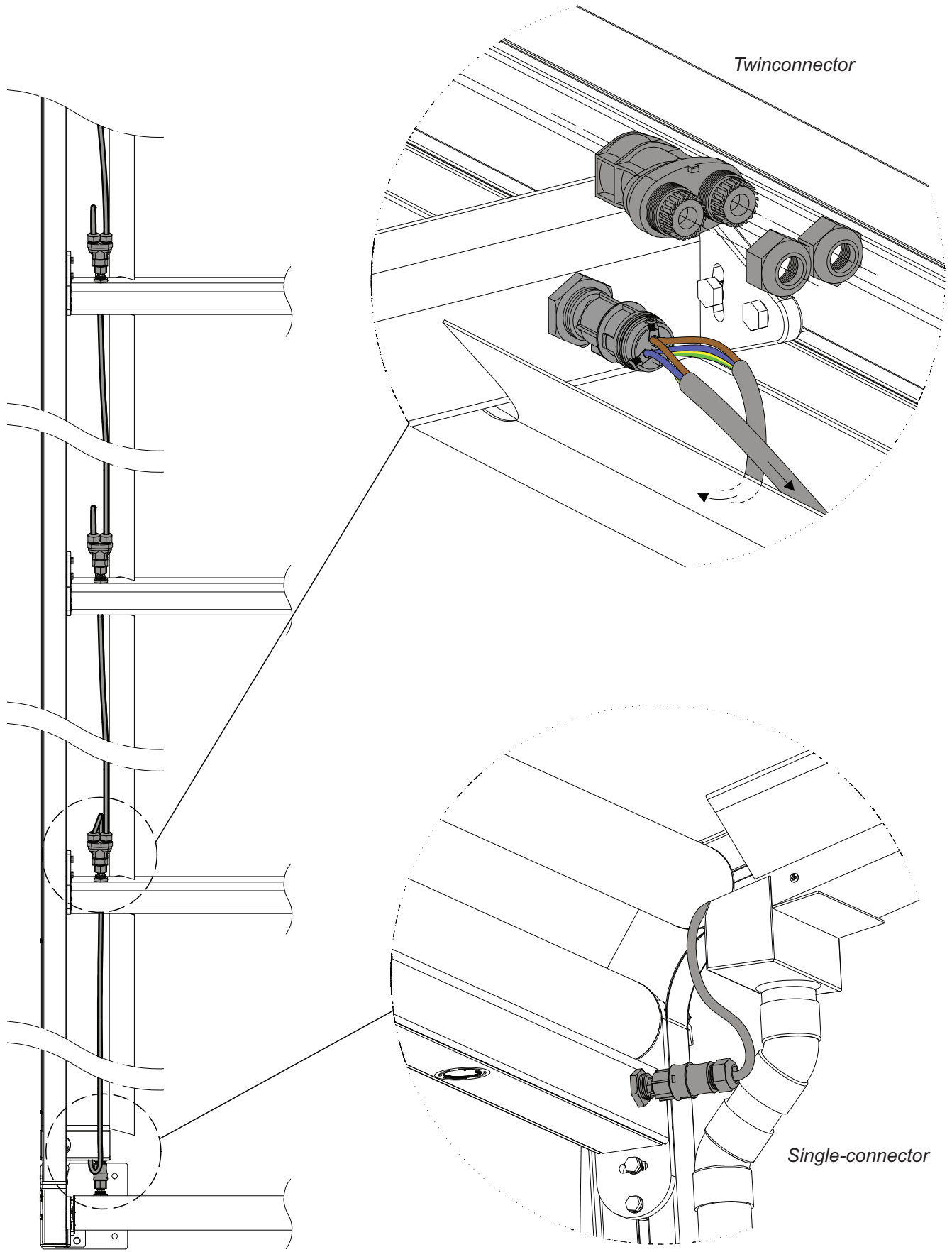

! Outside connection = IP 66/68 = completely weather proof



Maximum width as a function of the straight projection

Straight projection	Width
<i>Electrical operation</i>	
1000	5000
1500	5000
2000	5000
2500	5000
3000	5000
3500	5000
4000	5000
4500	5000
5000	5000
5500	5000
6000	5000

1 unit - electric operation - 1 motor

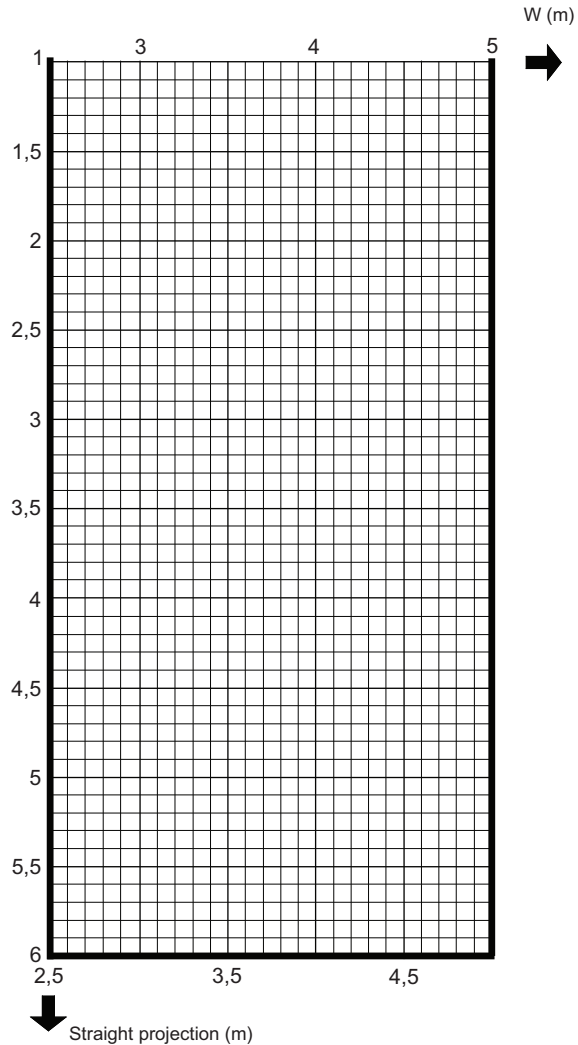

Number of intermediate rollers as a function of the straight projection

Straight projection	Number of intermediate rollers
0 ... 2000 mm	0
2001 ... 3500 mm	1
3501 ... 5000 mm	2
5001 ... 6000 mm	3



The spring system in the case

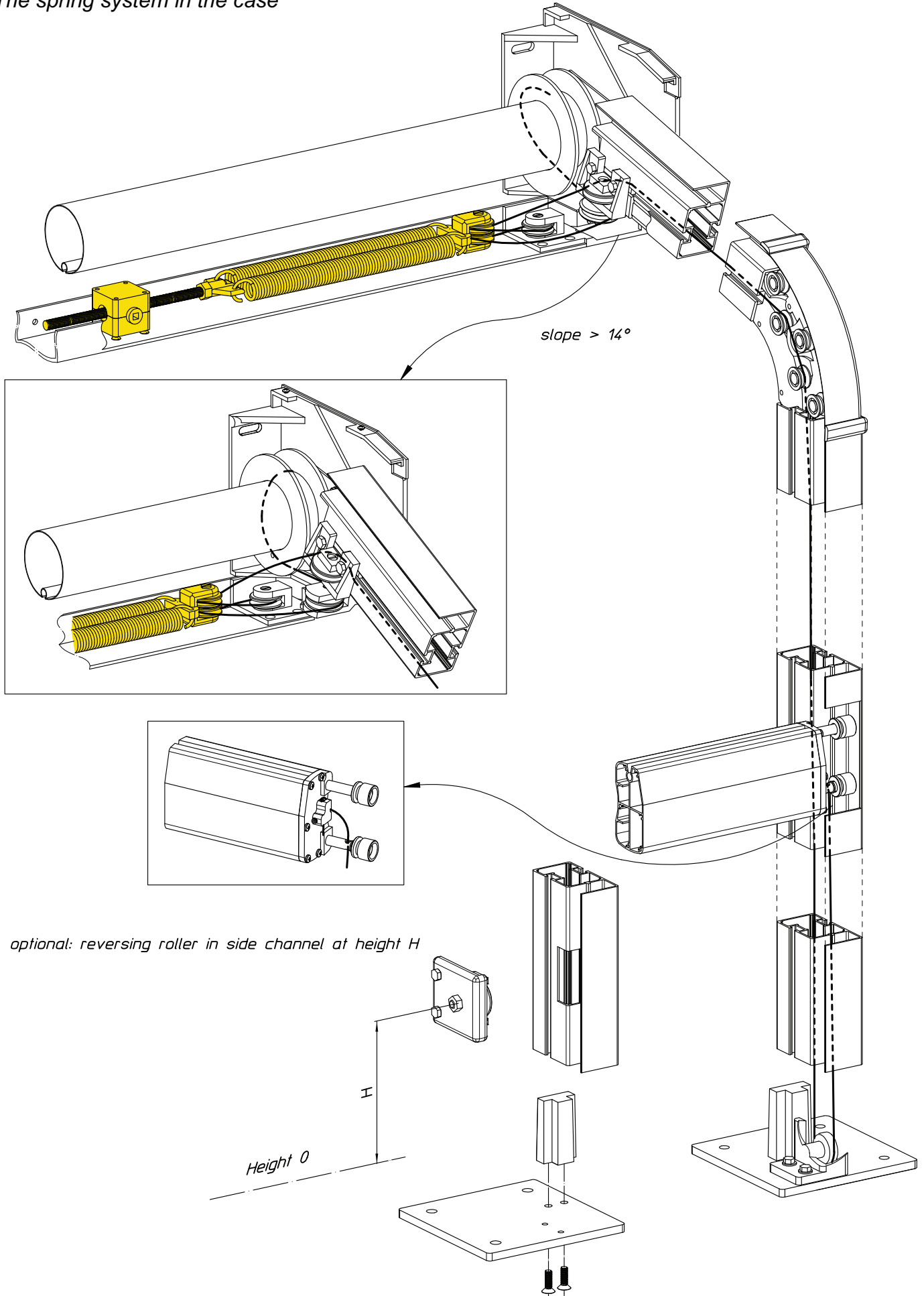



patiola®

patiola® ST 3300
measurements parts

E468/138

01/06

Side end cap left

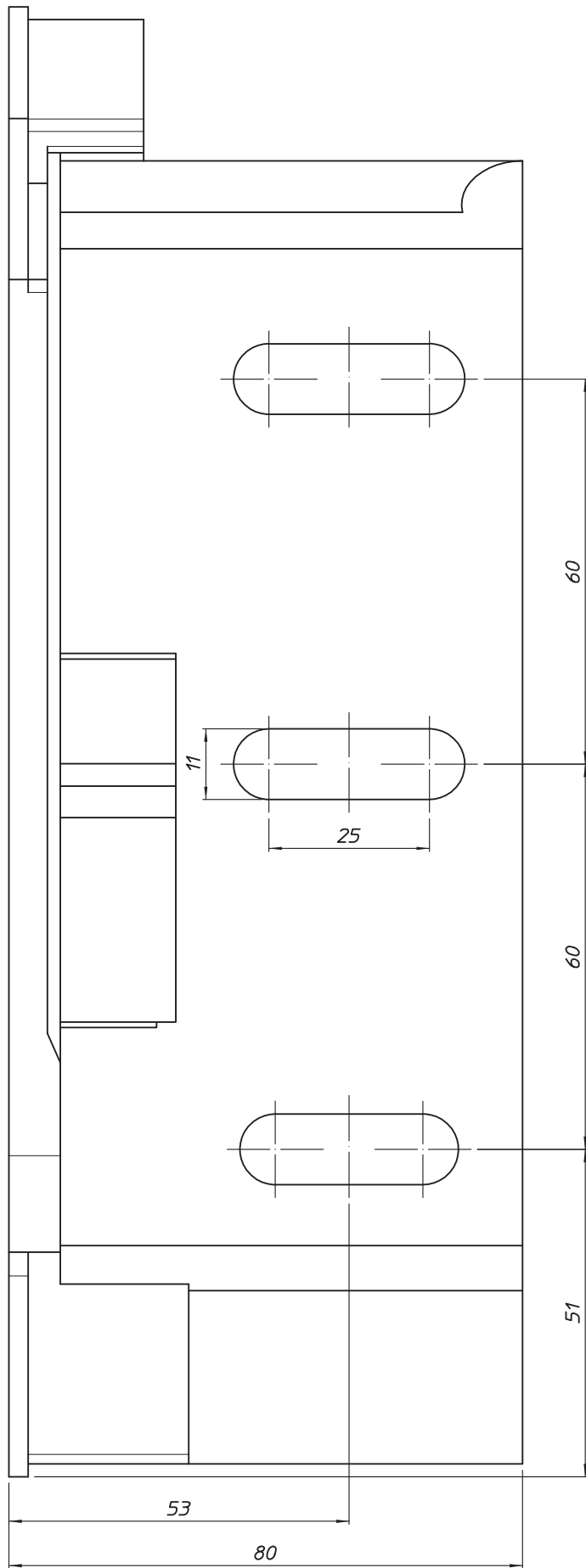

Side end cap right

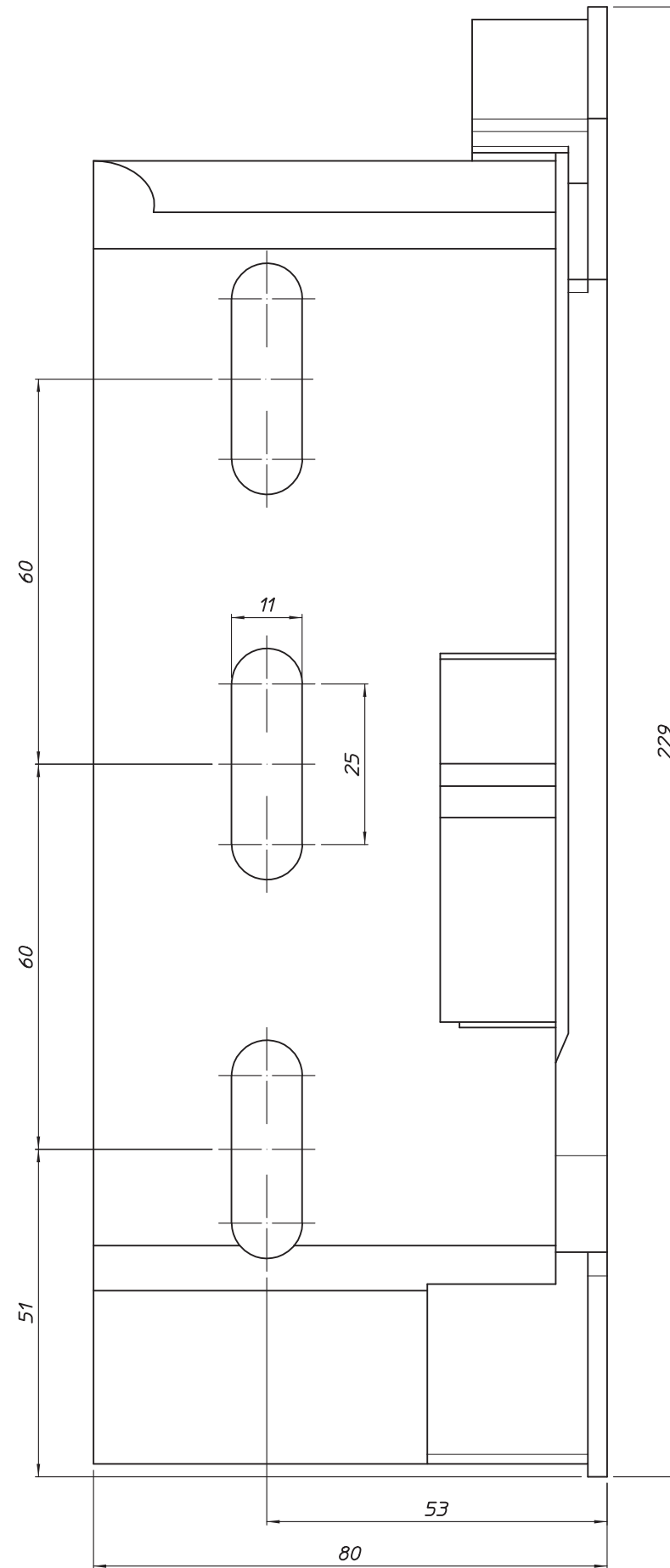

Side channel

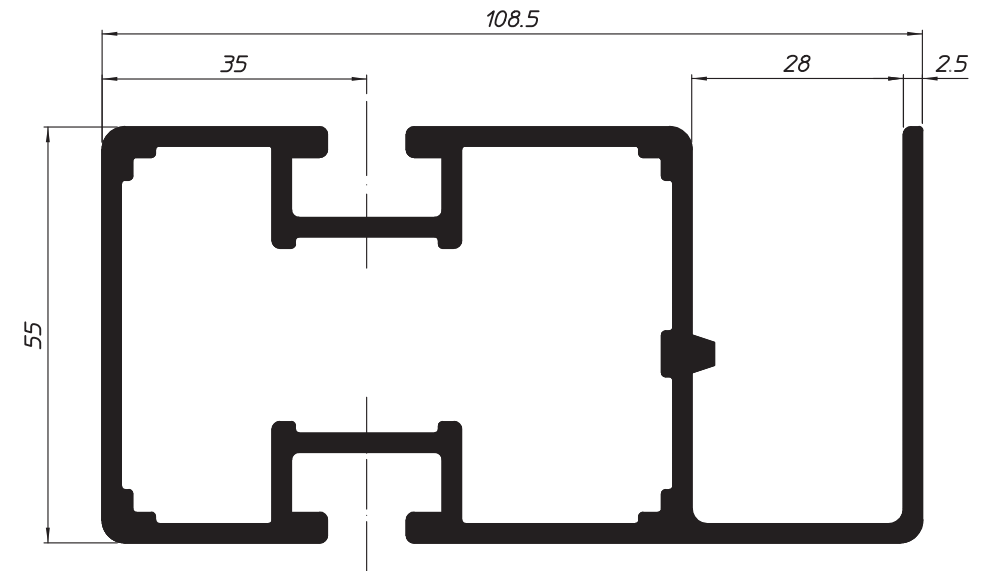

scale 1/1

Front profile

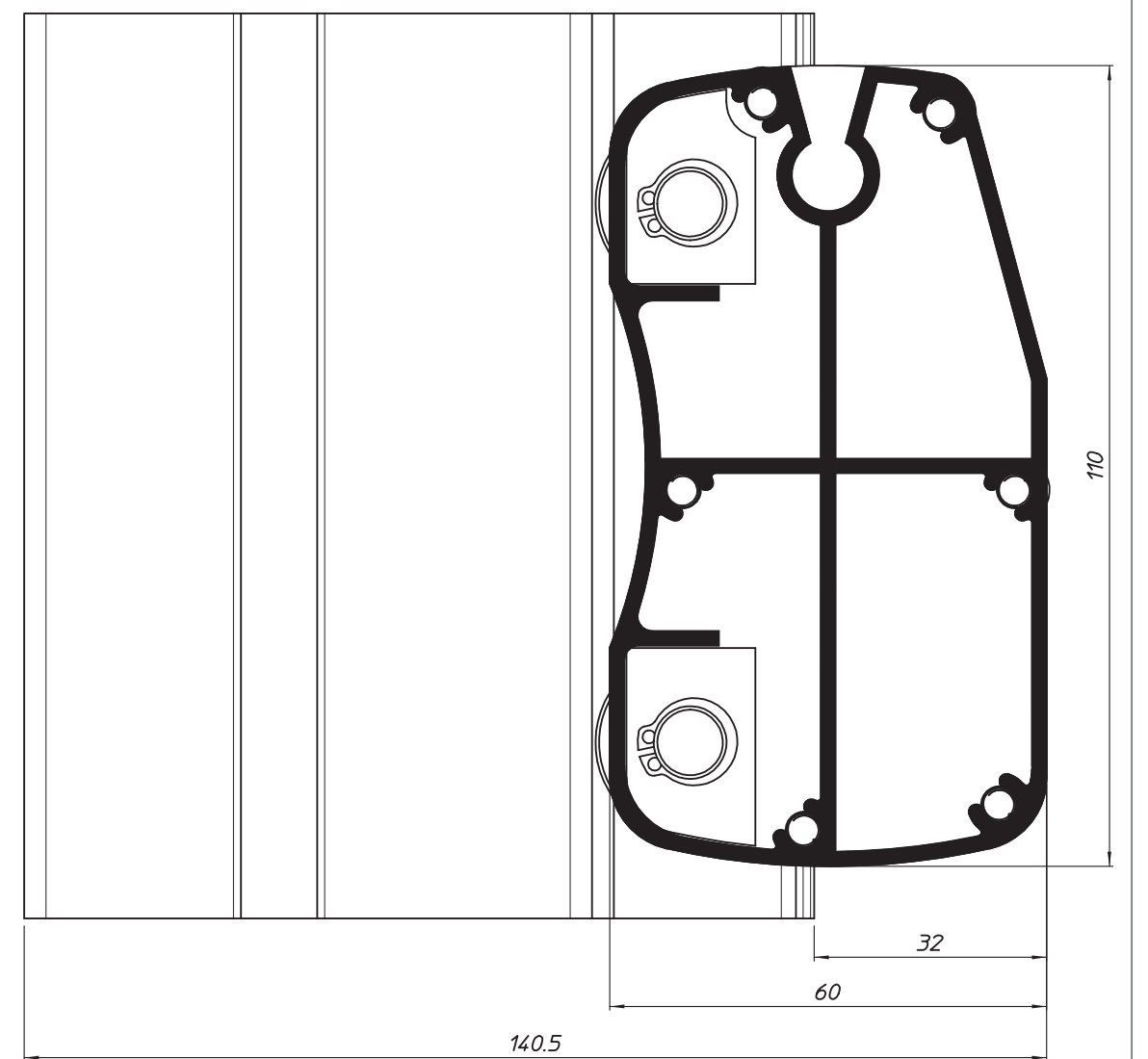



patiola®

patiola® ST 3300
measurements case

E468/137

01/06

scale 1/1

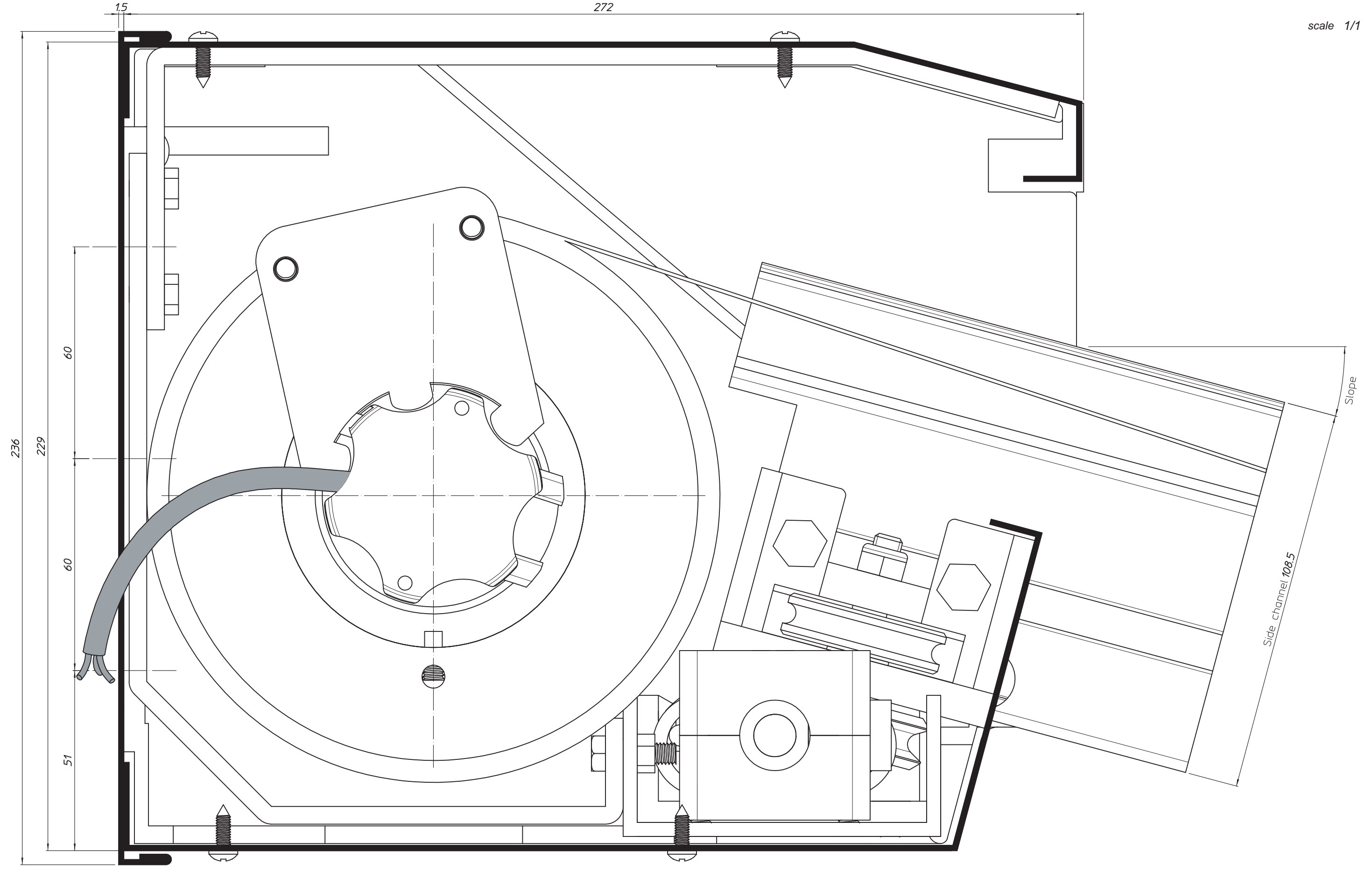

Side view

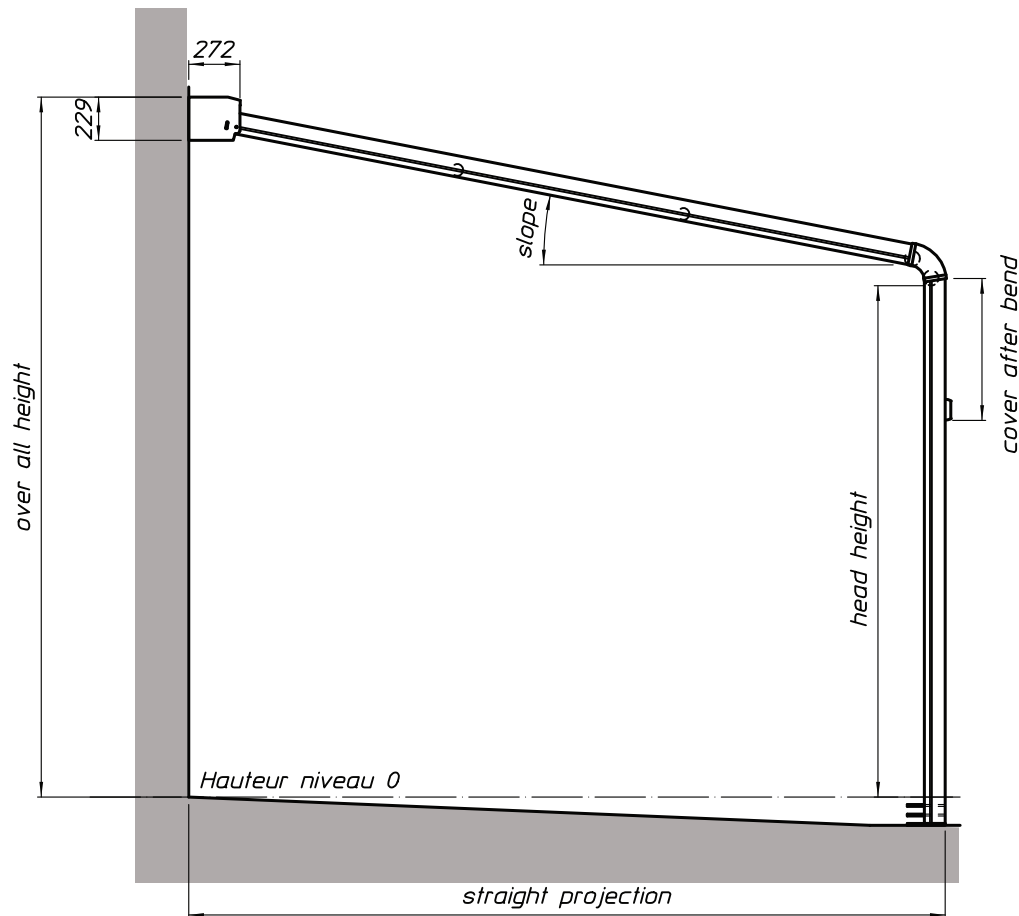

Over all width B1	=	_____ mm
Over all width B2	=	_____ mm
Over all width B3	=	_____ mm
Over all width total	=	_____ mm
Measurement width side channels B1	=	_____ mm
Measurement width side channels B2	=	_____ mm
Measurement width side channels B3	=	_____ mm
Measurement width side channels total	=	_____ mm
Width between side channels B1	=	_____ mm
Width between side channels B2	=	_____ mm
Width between side channels B3	=	_____ mm
Straight projection	=	_____ mm
Over all height	=	_____ mm
Head height	=	_____ mm
Cover after bend	=	_____ mm
Slope	=	_____ °
Number of intermediate rollers Ø 63	=	_____
Number of corner rollers Ø 80	=	2
Level difference side channel B1 left	=	_____ mm
Level difference side channel B1 right	=	_____ mm
Level difference side channel B2 left	=	_____ mm
Level difference side channel B2 right	=	_____ mm
Level difference side channel B3 left	=	_____ mm
Level difference side channel B3 right	=	_____ mm

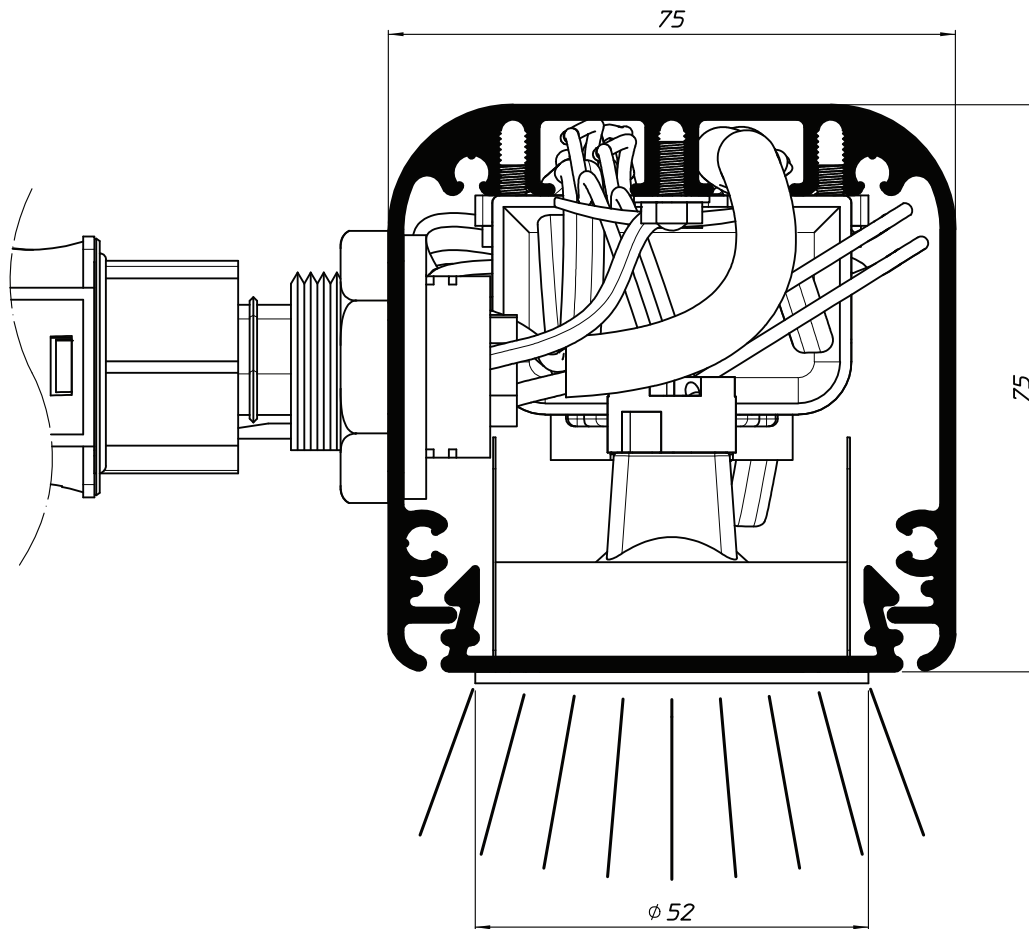

Technical properties:

Branch off the lighting bar to an installation that meets the local standards.

- Voltage: AC 230 V, 50 Hz
- Electrical cables 3 x 1.5
- Differential 0.03 A to power supply
- Rated current 16 A
- Capacity: 3 x 20 W to 6 x 20 W
- IP- value: 33

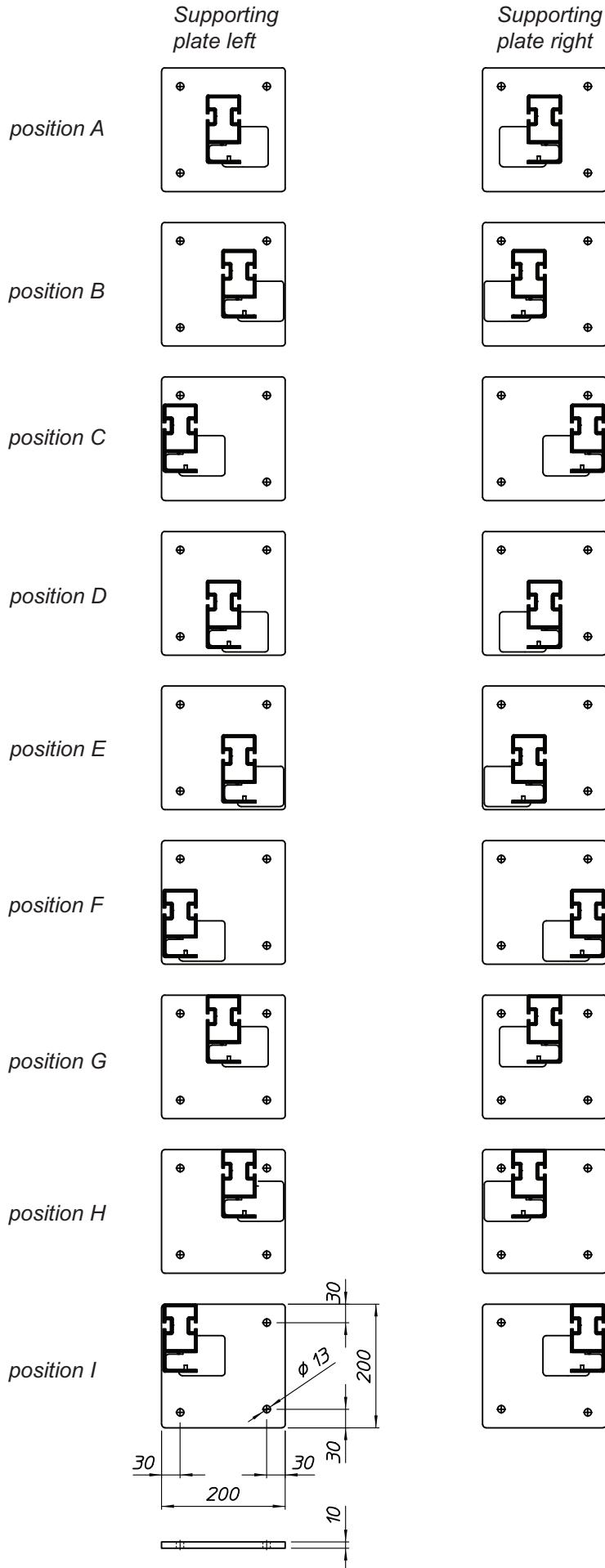

Front view

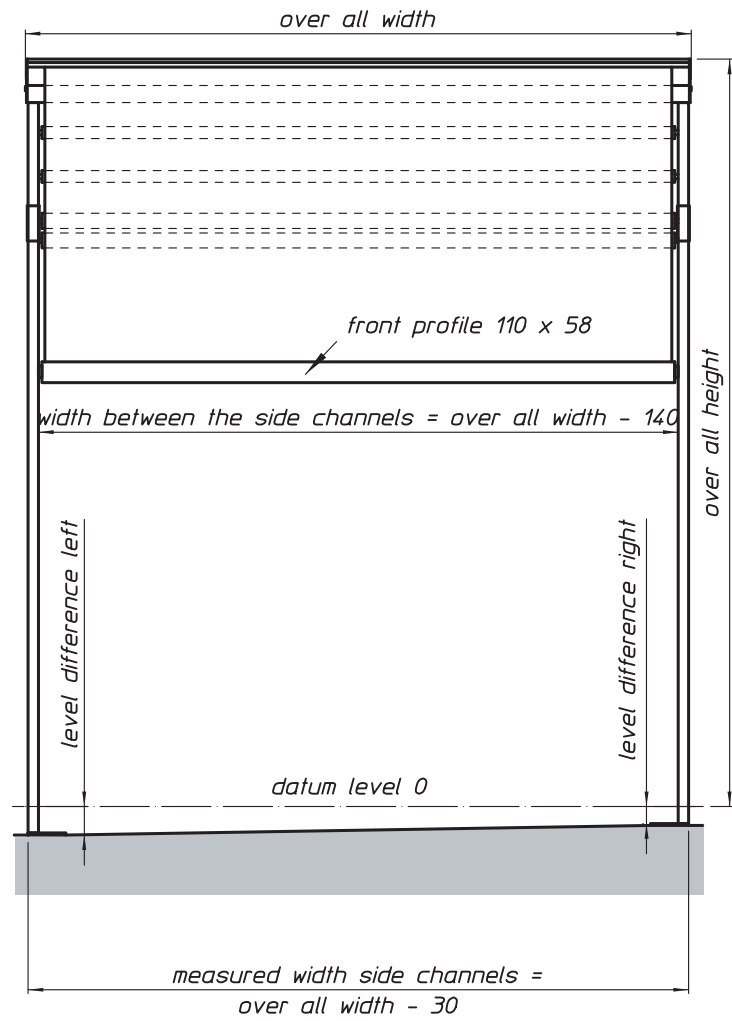

Side view

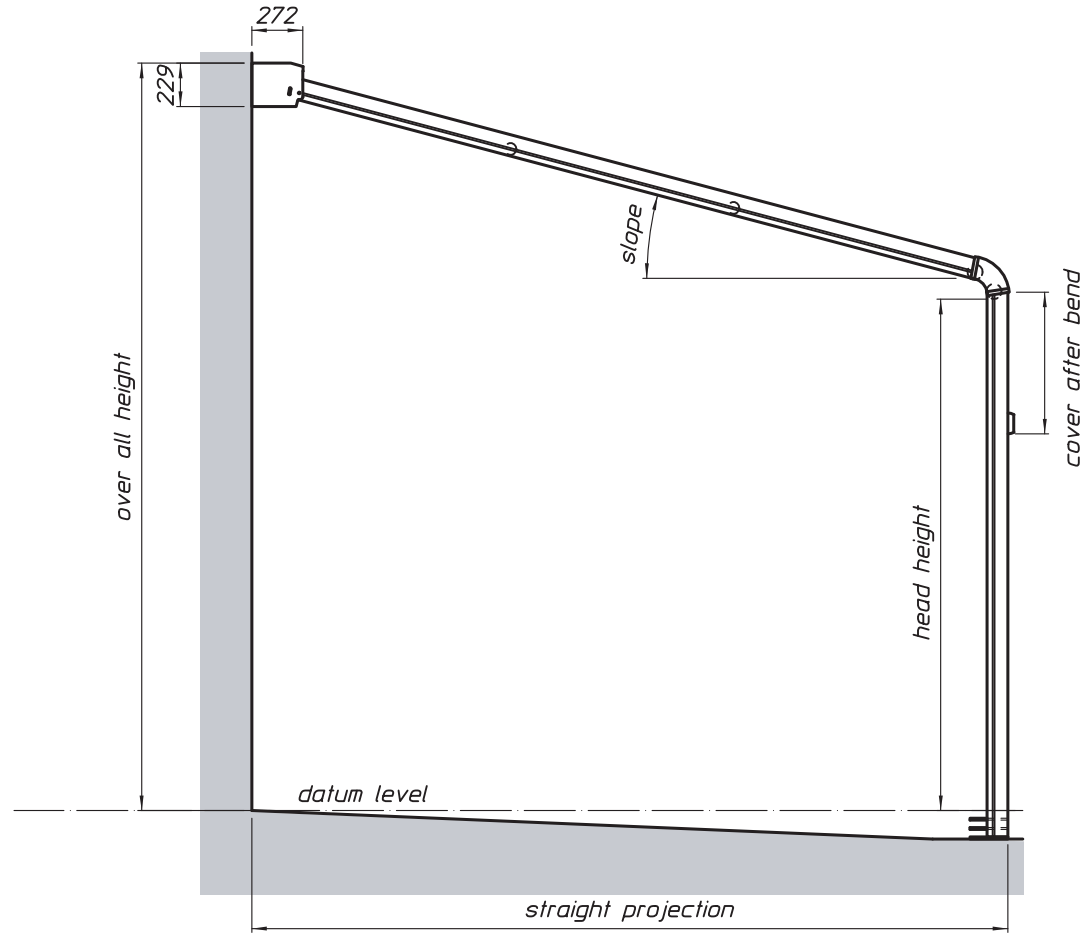

patiola[®]

patiola[®] ST 3300
Measurement 1 part

E468/133

01/06

Top view

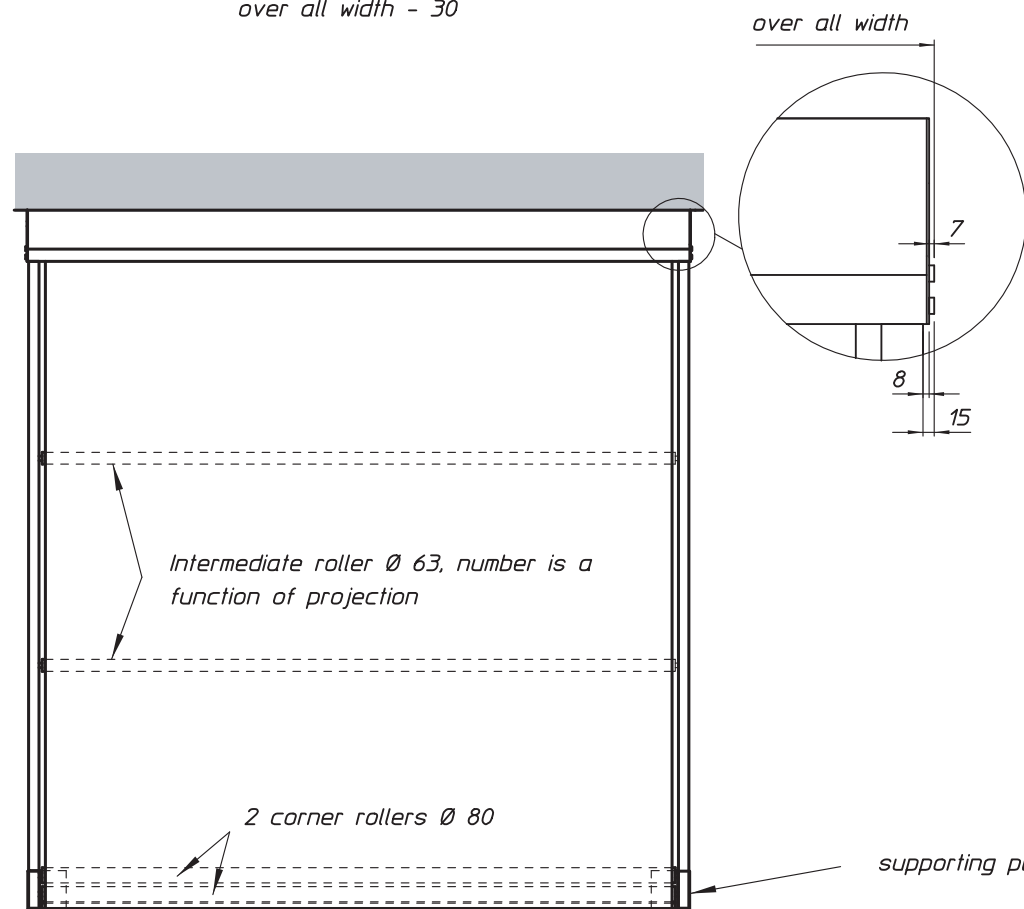

Over all width	=	_____ mm
Over all width side channels	=	_____ mm
Width between side channels	=	_____ mm
Straight projection	=	_____ mm
Over all height	=	_____ mm
Head height	=	_____ mm
Cover after bend	=	_____ mm
Slope	=	_____ mm
Number of intermediate rollers Ø 63	=	_____ °
Number of corner rollers Ø 80	=	2
Level difference side channel left	=	_____ mm
Level difference side channel right	=	_____ mm

Amount of spots in relation to the width of the lighting bar

Width	Amount of spots
2250 ... 3000 mm	4
3250 ... 4000 mm	5
4250 ... 5000 mm	6



patiola®

patiola® ST 3300
Wiring diagram

E468/161

01/06

Wiring diagram 1 transformer

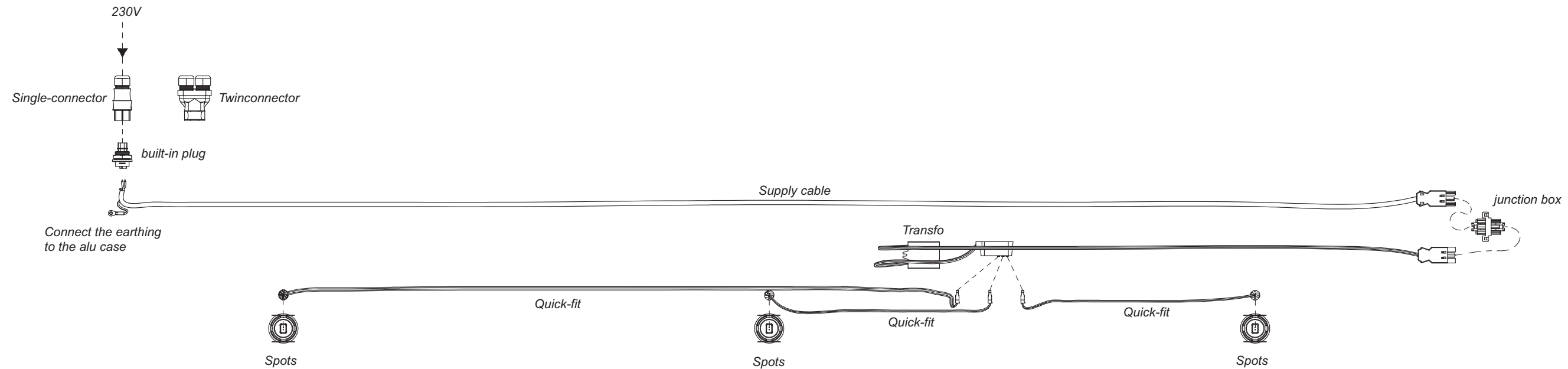

Wiring diagram 2 transformers

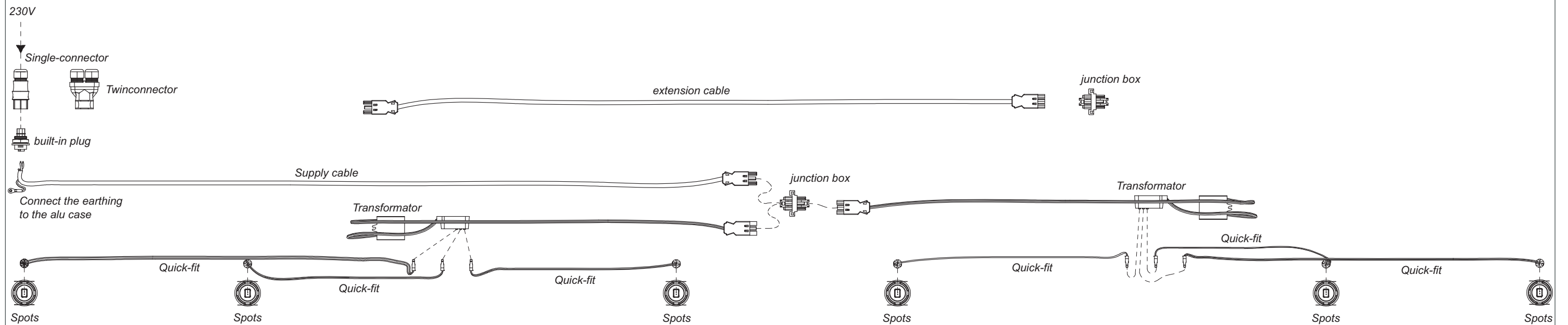



patiola[®] ST 3300

Awning with case and side channels, especially designed as a terrace roof. The case contains a roller tube with fabric, motor drive and a spring system. Totally self-supporting system: fixed with the end caps of the case to the wall, and the footplates to the ground.

- **Case:** rounded case, 229 x 272 mm, made of folded aluminium. The aluminium side end caps have a hole and a groove to attach the sloping side channels. The side end caps are assembled with stainless steel screws and aluminium rivets. The case is closed with a detachable cover plate; this allows easy access to the roller tube.

- **Side channels:** extruded aluminium profile 55 x 110 mm, this profile has a U-shape within which the cord-wheel of the front profile rolls, and a matching space for the end parts of the corner pieces. There are another 2 grooves for fixing the intermediate rollers and the side end caps. Corner pieces, which allow a maximum slope of 25°, connect the vertical and the sloping part of the side channels. We recommend a minimum slope of 10° for good water-drainage. Two corner rollers Ø80 mm are assembled into the corner pieces, which support the fabric. Depending on the projection, further intermediate rollers, Ø63 mm, are built into the sloping part to support the fabric. Adjustable footplates fix the vertical side channels onto the ground.

- **Spring system:** a rope and pulley wheels pull the fabric up and down. The tension of the fabric is produced by a spring system built into the case. The springs are attached with a threaded bar to a winding system with a handle. This winding handle allows you to adjust the spring tension. The spring system in the side channel is built in during manufacture.

- **Front profile:** double hollow section, 110 x 58 mm, made of extruded aluminium. This profile has a slot where the cover and fillet are attached. The ends are closed with bungs made of extruded aluminium fitted with synthetic wheels, which roll in the side channels.

- **Finish of case, side channels and front profile:**

* powder coated - electrostatic spray process with polyester powder

- blanc RAL 9010
- ivory RAL 1015
- any other RAL colour

- **Fabric:** absorbs and reflects the solar heat. The top and the bottom have a hem where the fillet is inserted. The fabric exists of waterproof quality. Extended choice of colours and patterns are available.

* **waterproof fabric** (collection 50TT):

- weight: +/- 300 g/m²
- water proofness 750 mm - according to NF G 07.057. Shopper test 8L: water column 10 cm high : 24 hr ok
- tension on a 5 cm sample:
warp 140 daN - weft 80 daN
- tearing resistance:
warp 45 daN - weft 20 daN
- thickness: +/- 0,43 mm
- fire category: none

- **Operation:** the fabric is rolled up on a profiled galvanised steel tube Ø85 mm. Fillet is inserted into the hems of the cover; the hem is engaged with a groove in the tube. This tube is supported at each end on bearings and is driven by a built-in electric motor. The tube motor is single phase 220 Volt with a power of 320 to 410 Watts and a torque of 80 to 100 Nm. The motor is supplied with a limit switch that stops the motor automatically when the fabric is fully extended or retracted. A built-in thermal overload switch protects the motor against overheating (caused by repeated winding in and out). The motor is controlled with a switch; which can be recessed or surface mounted; or remote control.

- **Options:**

- * back plate
- * gutters
- * side blends
- * steering for fabric tension (CMTI)
- * lighting bar

- **Lighting bar:** the cassette of the lighting bar is made of extruded aluminium, enamelled and available in various RAL colours. The side plates are made out of aluminium, enamelled and powder coated in the same colour.

The armature of the spots are made of brushed aluminium with an after-treatment so they don't need to be powder coated = only available in natural colour. There are slots foreseen in the armature of the spot. They take care of the ventilation and heat reduction from the spots. Only parts with a hallmark, which proved their efficiency, are used for the electrical interior. A choice has been made for a "plug and light" system. Installing and replacing parts can be done in a very easy and quick way. The used transfos are electronic and have dip safety transformers, conform to the European norms and conform to the low-tension guides.

The outside connection exists of a plug system (IP66/68) that is waterproof. The outside cable needs to be connected to the plug according to the foreseen polarization.

Front view

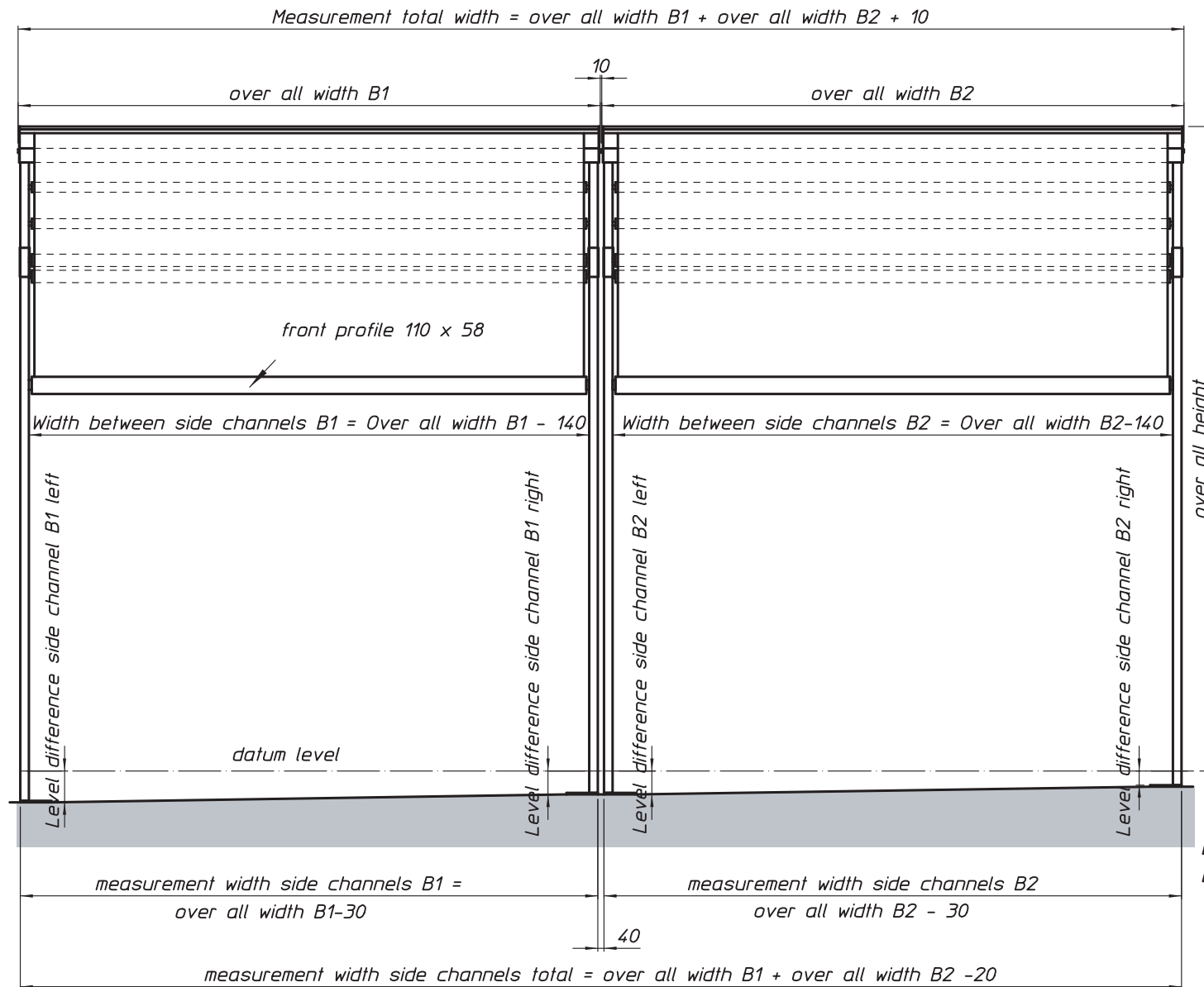

Side view

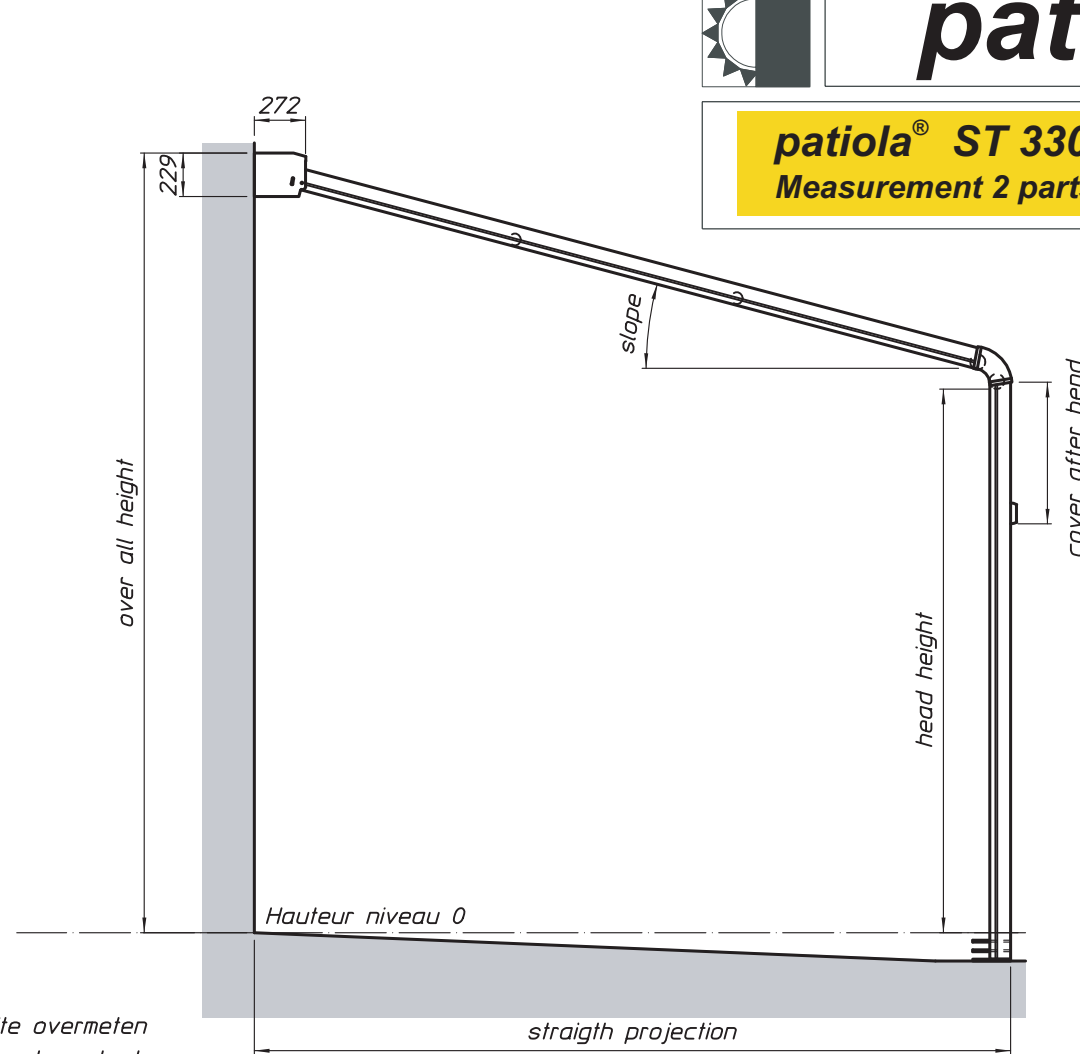

patiola®

patiola® ST 3300
Measurement 2 parts

E468/134

01/06

Top view

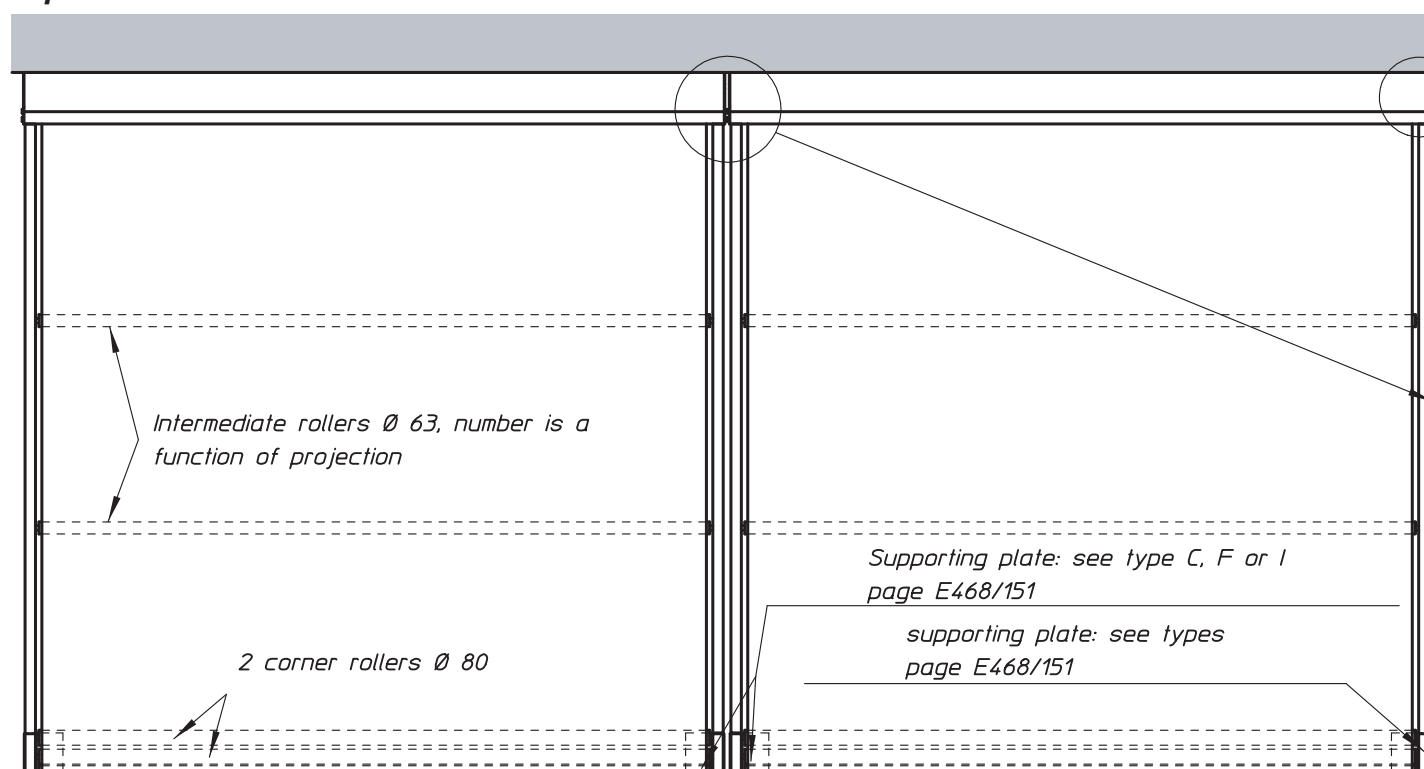

Breedte overmeten
Largeur hors tout

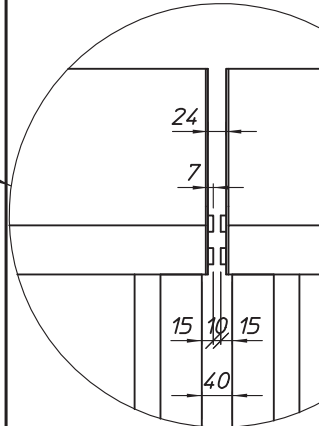
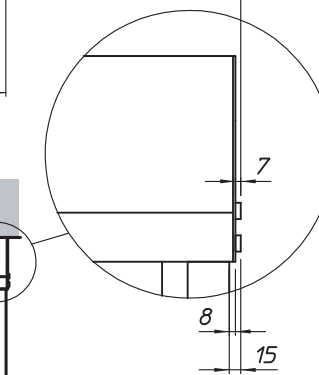

Over all width B1	=	_____	mm
Over all width B2	=	_____	mm
Over all width total	=	_____	mm
Measurement width side channels B1	=	_____	mm
Measurement width side channels B2	=	_____	mm
Measurement width side channels total	=	_____	mm
Width between side channels B1	=	_____	mm
Width between side channels B2	=	_____	mm
Straight projection	=	_____	mm
Over all height	=	_____	mm
Head height	=	_____	mm
Cover after bend	=	_____	mm
Slope	=	_____	°
Number of intermediate rollers Ø 63	=	_____	
Number of corner rollers Ø 80	=	2	
Level difference side channel left B1	=	_____	mm
Level difference side channel right B1	=	_____	mm
Level difference side channel left B2	=	_____	mm
Level difference side channel right B2	=	_____	mm



patiola[®]

patiola[®] ST 3300
Exploded view

E468/130

01/06

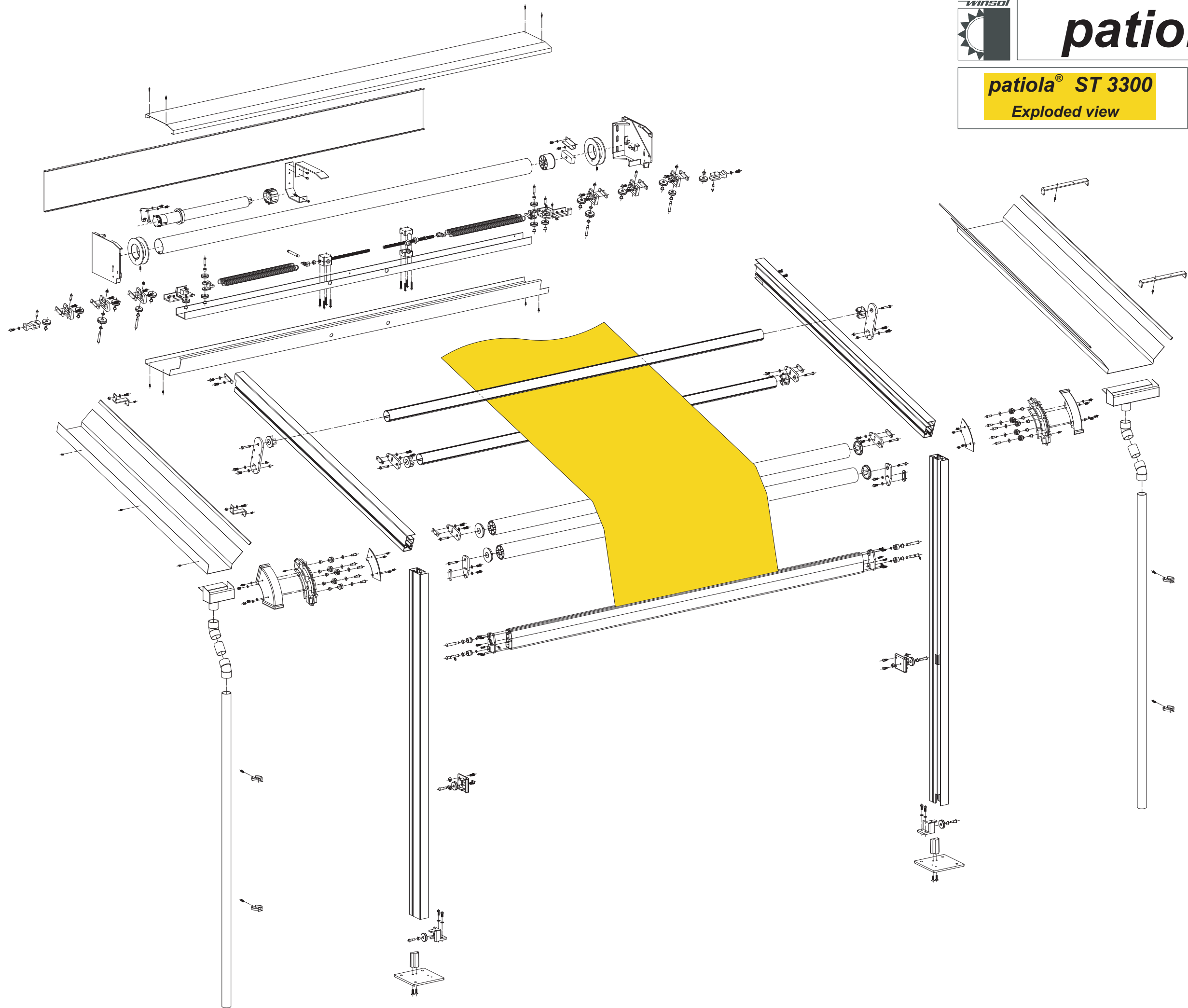



patiola®

patiola® ST 3300
Gutters

E468/150

01/06

scale 1/2

Gutter 160 mm

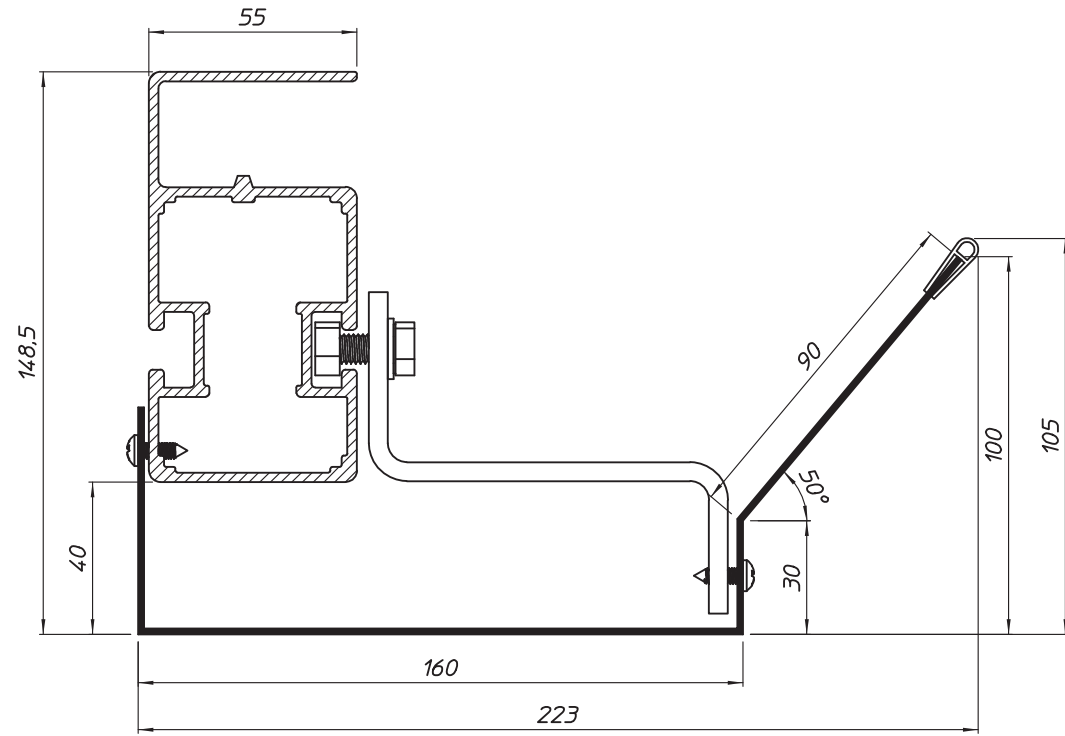

Gutter 300 mm for 2 patiolas placed next to each other

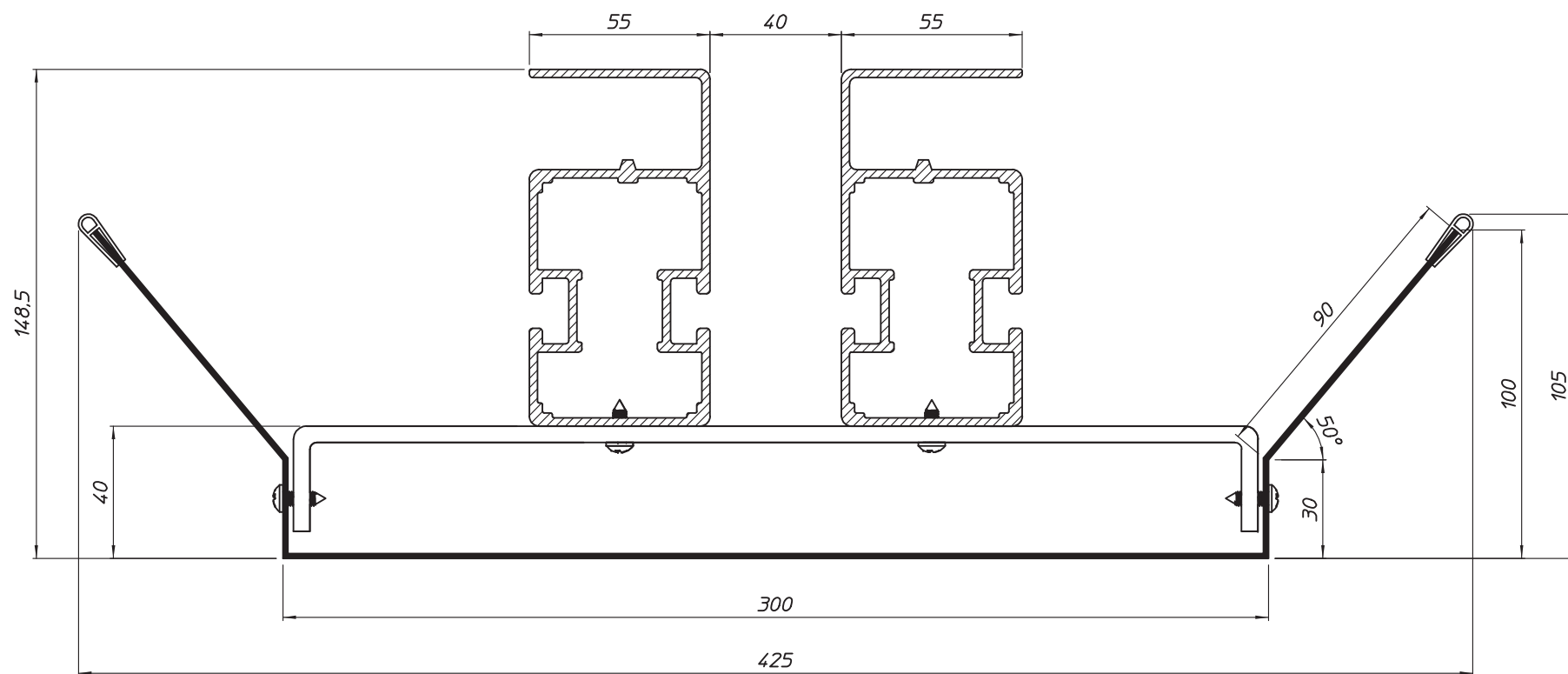

Left gutter 160 mm

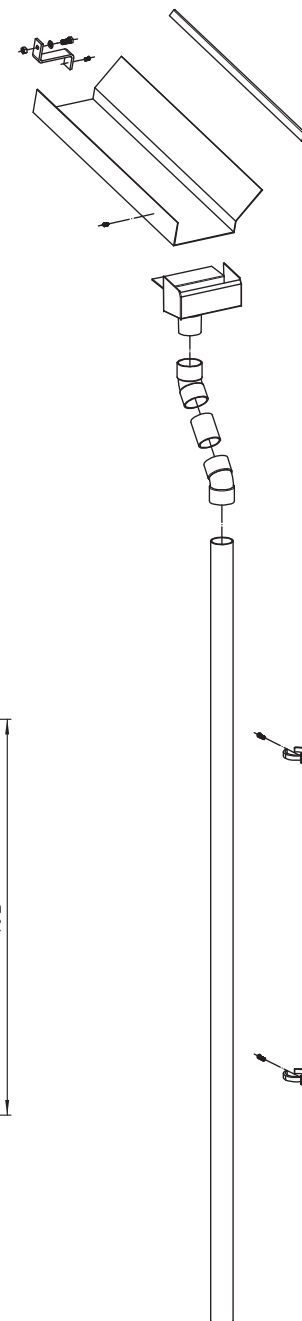

Gutter 300 mm

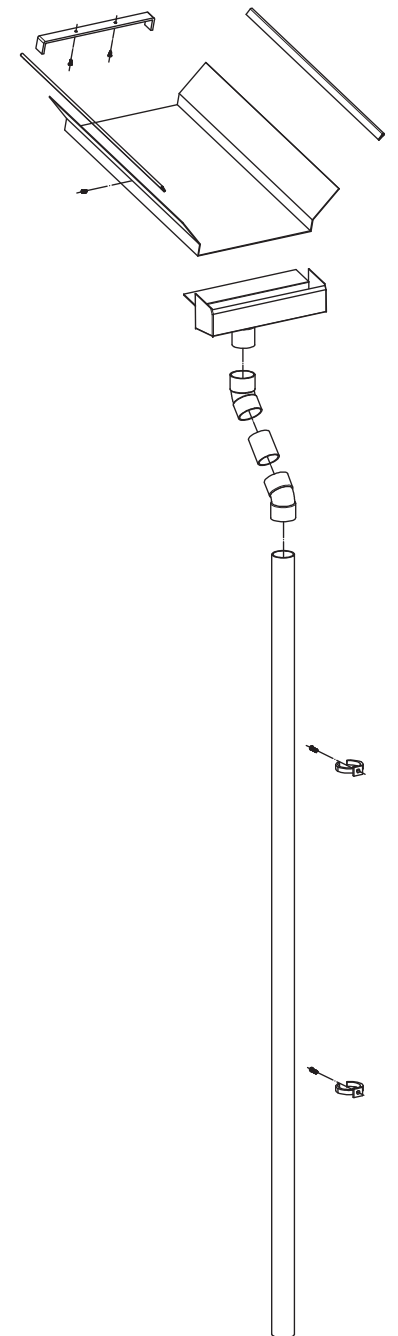

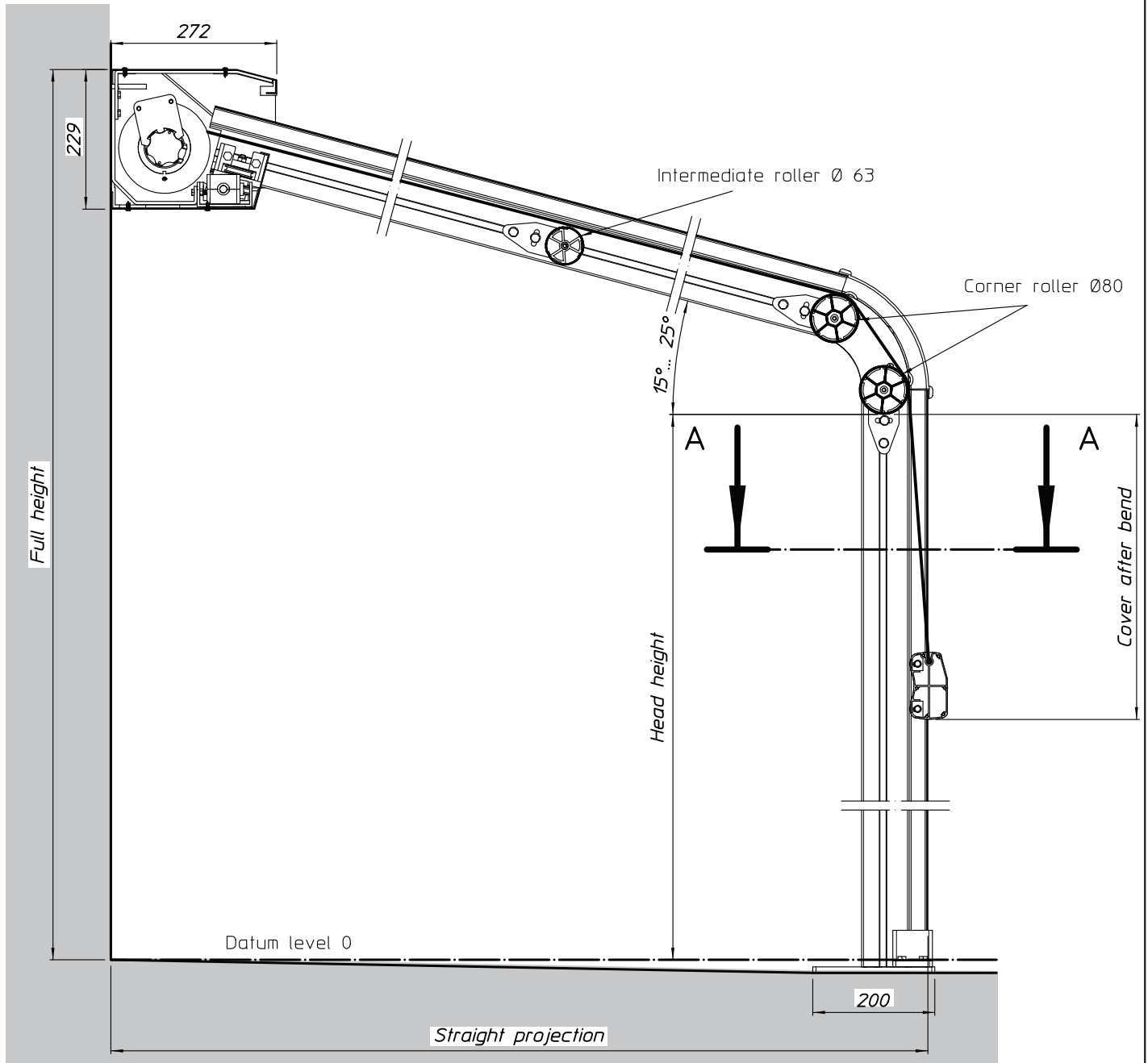

Section A - A'

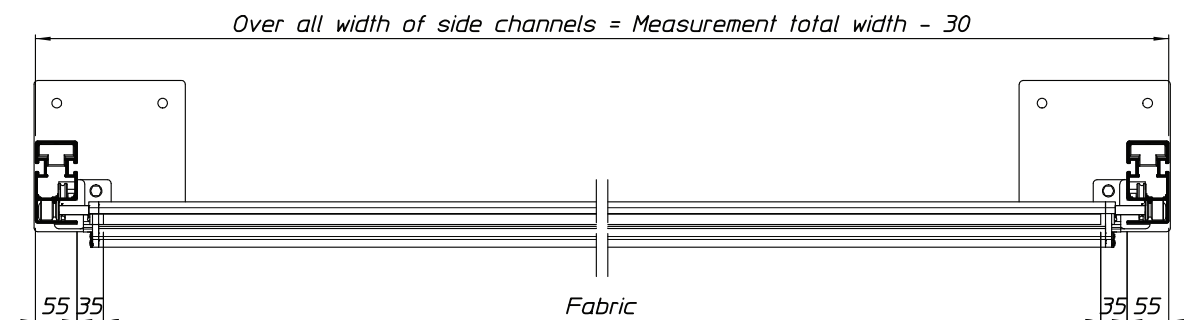

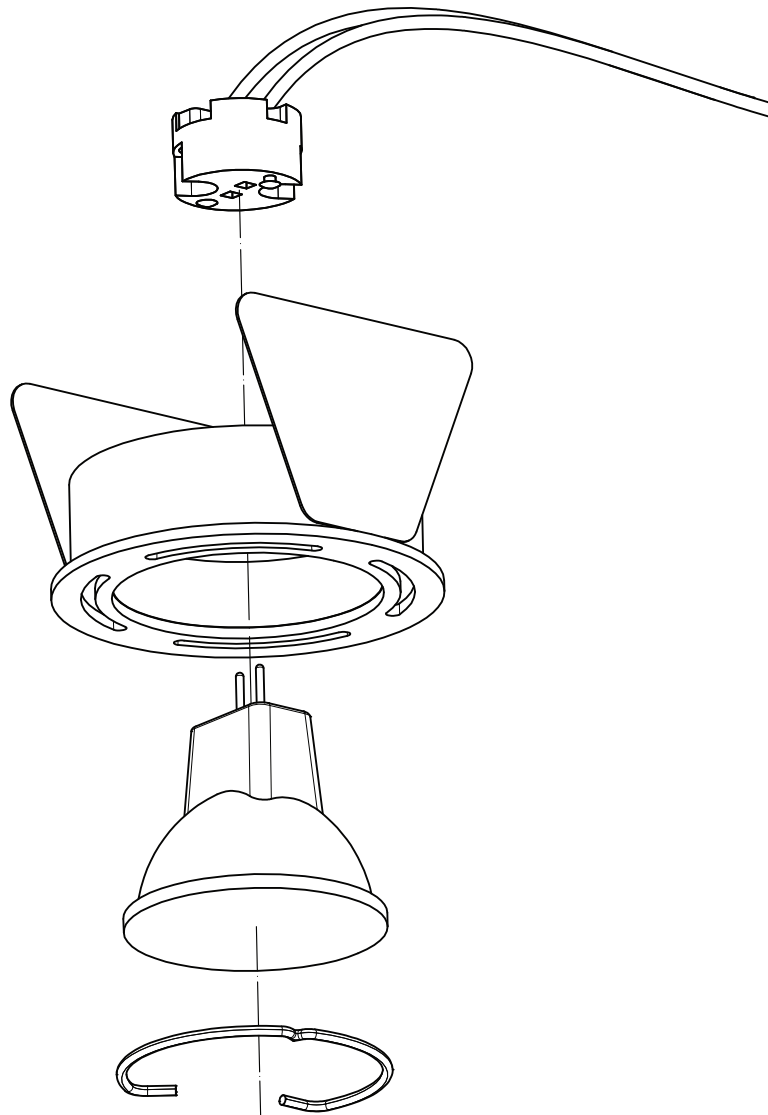

Replacing spot

- Loosen the spot ring in the armature.
- Remove spot & socket from armature.
- Remove spot from socket and replace...

Remark: always use spots of following type:

Halogen dichroic GU4 AE 35 mm.

12V - 20W.